

# Operating Procedure For Precision Cleaver S321,S321B

## 1. Applicable Fiber Type for S321,S321B

type	cleave length	used holder or adapter
Single fiber Coating Diameter, 0.25 or 0.9mm	5 to 20mm	Supplied Single Fiber Adapter
Ribbon fiber 0.25mm pitch 2 to 12 fiber	10mm	Optional Ribbon Fiber Holder

## 2. Name of parts

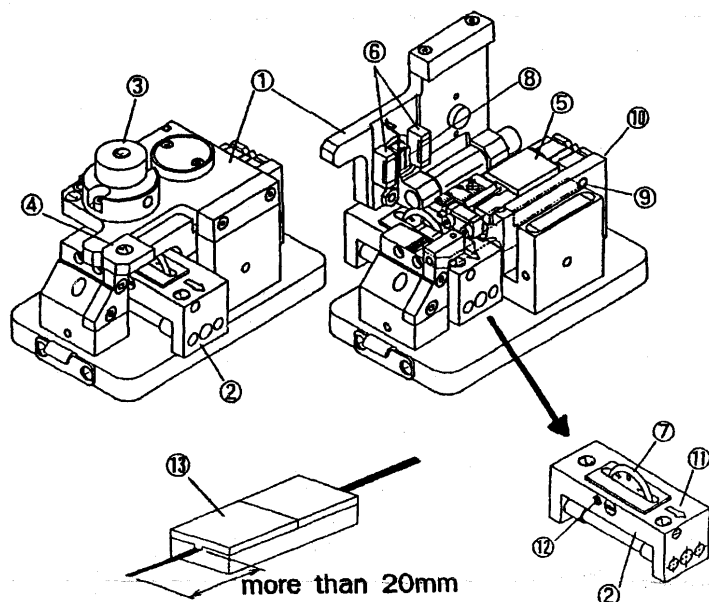

- 1 Cover
- 2 Sliding Blade Assembly
- 3 Cleave Button
- 4 Cover Release Lever
- 5 Interchangeable Fiber Holder affixed using screws #9 and #10
- 6 Clamping Blocks
- 7 Blade
- 8 Bending Pad
- 9 Retaining Screw for Fiber Holder
- 10 Locking Screw for Fiber Holder
- 11 Arrow Indication Direction for Sliding Blade Assembly when cleaving
- 12 Blade Set Screw
- 13 Fiber Holder

## 3. Working Steps

- 1) Press cover release lever (#4) to open cover (#1).
  - 2) Slide blade assembly back (opposite direction of arrow) to prepare for cleaving.
  - 3) Using appropriate fiber holder, place a prepared fiber (stripped and cleaned) across cleaving area. Ensure that the stripped fiber is long enough to extend across both rubber pads. If using ribbon fiber, check that the fibers are aligned with the marked lines adjacent to the rubber pads and that no fiber overlap each other.
  - 4) Close cover (#1) and slide the blade assembly in direction of arrow.
  - 5) Press cleave button (#3) until click is heard.
  - 6) Press cover release lever (#4) to open the cover and remove the cleaved fiber.
  - 7) Remove and dispose the loose fiber from the cleaving area.
- Caution :** Special care should be taken in handling loose fiber.

## 4. Maintenance and Adjustment

- 1) When the unit fails to cleave a fiber, some maintenance may be necessary. With the use of lint-free tissue or cotton stick soaked in denatured alcohol, clean off the cutting edge of the blade (#7) and also the rubber pads where the fiber is placed.  
**Caution :** Do not use Acetone for cleaning rubber pads.
- 2) If after cleaning the unit still does not cleave, the blade may need to be rotated to the next position. To rotate blade, loosen blade set screw (#12), turn the blade to the next position (numbered on the blade) and then re-tighten the blade set screw.

## 5. Contact unit

THE FURUKAWA ELECTRIC CO., LTD.

Head Office : 6-1 Marunouchi 2-chome, Chiyoda-ku, Tokyo, 100-8322 Japan

Engineering department, FITEL Products Division, Information Systems Group

Tel : 81-3-3286-3443

Fax : 81-3-3286-3708